

copy 100

NATIONAL AERONAUTICS & SPACE ADM.
STORAGE TRAILER
SERIAL-040-60258
GODDARD SPACE FLIGHT CENTER
GREENBELT, MARYLAND

COPY



NORTHLAND CAMPS INC.

I N D E X

1. RUNNING GEAR
2. MAINTENANCE OF TRAILER
3. SHIPPING LOCATION DRAWINGS FOR TIE DOWNS
4. MATERIAL LISTING (LIVE LOADS) OF TRAILERS
5. GUARENTEES & INSTRUCTIONS
6. ELECTRICAL DRAWING FOR EACH TRAILER.



NORTHLAND CAMPS INC.

NAMPA, IDAHO

- MAINTAINANCE OF TRAILER -

NASA TRAILERS, NCI SERIAL NUMBERS: 040-60257, 040-60258, 040-60259,
040-60260

1. Normal cleaning practices pertaining to care of walls, floors, etc., will suffice to prolong life of trailer.
2. Storage & maintenance shelving is of Dexlon Metal & Care consists of tightening bolts to insure proper shelving space.
3. Windows are Hehr 3600 Series and 100 Series and need no special care other than cleaning of glass.
4. Lamp fixtures are incandescent type, porcelain coated and need no care other than normal cleaning and bulb replacement.
5. Doors and Superior Type c/w screen need no maintenance other than normal care.
6. Exterior metal is aluminum c/w baked enamel surface and needs no special care other than an occasional washing to remove dirt, etc.
7. All plumbing fixtures have been tested and normal care and cleaning is all that is needed.
8. BE SURE TO FILL WATER HEATER BEFORE ACTIVATING HEAT COILS.
9. BE SURE TO GROUND TRAILER WITH GROUND ROD BEFORE TURNING ON ELECTRICITY.
10. All tools and air conditioners have their own care and maintenance manuals. These procedures should be followed.
11. It is recommended that fire extinguisher be recharged every 12 months.
12. 50 MPH is the design limit for each trailer on the highway.
13. Diffusers in each trailer should be kept free from dust and lint for best operation.
14. Desks are metal and normal cleaning with soap and water will suffice.
15. All desks and filing cabinets are secured to the floor and walls for shipping and should be replaced in exact locations for future shipments.
16. Secure equipment as per drawing enclosed for each trailer.
17. Leveling jacks are located underneath the I-beam crossmembers of the main frame. For use, the retaining pin holding the jack in traveling position is removed, allowing the jack to swing down to operating position. The jack is operated by means of the handle provided. Leveling can be checked by means of the level vials located on the outside corners of the trailer.

FAYETTE "SERVICE TIPS" MANUAL

Fayette Manufacturing Company
Fayette, Ohio
Manual No. 2

PACKING YOUR BEARINGS AND HUB-DISASSEMBLY & ASSEMBLY

FAYETTE "SERVICE TIPS"

PACKING YOUR BEARING AND HUB-DISASSEMBLY & ASSEMBLY

The re-lubrication of front wheel bearing is possibly the most important service to keep your trailer in top operation condition.

However, the two most important phases of this operation are cleanness and proper adjustment.

In carrying out this operation the utmost care must be exercised in maintaining extreme cleanness and all component parts must be kept free from dirt and grit.

There is no use in re-lubricating the bearings if they are not reassembled and adjusted correctly and therefore proper adjustment cannot be over-emphasized in this "Service Tips" sheet.

Before dis-assembling the hub check for further reference, wheel play and freedom of rotation. Extreme or excess wheel play indicates too loose adjustment or worn or broken bearings. Drag in rotation could indicate, the brakes are over adjusted and holding the drum too tight or tightness in bearing adjustment or a defective or broken bearing.

To begin dis-assembly, remove the dust cap and pry loose the cotter pin. The cotter pin is to be discarded.

Next remove the large spindle nut and washer. Jiggle the wheel slightly to loosen the outside bearing. Usually the outside bearing will loosen up enough to be removed by hand. If it doesn't, simply pull off the complete wheel and hub and all the bearing will come with the hub. It's a good idea to replace the dust cap lightly before this operation to insure that the bearings will not fall on the floor. Cover the spindle with a cloth and brush the dirt free from the brakes and magnet assemblies.

Wipe the spindle clean with a dirt-free cloth. Remove the outer bearing from the hub and place a brass drift or a length of wood through the small end of the hub until it rests on the inside bearing assembly. Tap gently while revolving around the bearing until the grease seal is loose. Remove the grease seal and bearing assembly and wipe all dirt and grease from the inside of the hub.

PACKING AND INSPECTION OF YOUR BEARINGS

Clean thoroughly the inside and outside bearing cups, bearings, washer, spindle nut and grease seal. Dry the bearings and other hub components thoroughly. Cleanness must be maintained throughout this operation as any slight amount of dirt will cause bearing failure.

Inspect carefully cups and cones of bearing assemblies for pitting, scratches, excessive wear, or other damage. If either cups or cones are worn, pitted scratched or indented in any way replace the entire bearing assembly.

Use a bearing packer to pack your bearings with grease and be sure to force out all old lubricant and solvent. Coat lightly your bearings and bearing surfaces. Shell Oil Company Alvania #3, or equal, grease is specified for your trailer axle assembly. The outer cups should be replaced in the hub by means of a Arbor press. If one is not available you may tap the cup in place lightly by hand.

Install cone and bearing assemblies in the hub and tap the grease seal in place. Replace hub on spindle taking care not damage threads or the grease seal. Replace washer and spindle nut.

ADJUSTMENT

Rotate your wheel and tighten spindle nut until it binds lightly. Back off the nut one flat and check for wheel play. There should be .002 to .008 wheel play. Or if a torque wrench is available, torque the spindle nut to 75 ft/lbs. and back the nut off 1-2 flats or until there is .002 to .008 wheel end play.

Install cotter pin and bend into locked position.

Replace the dust cap.

This completes the disassembly, greasing, inspection, and reassembly of your hubs. Repeat this process on your other hub (S) and you will again be ready for 30,000 miles of carefree trailering.

Fayette Service Engineering Dept.

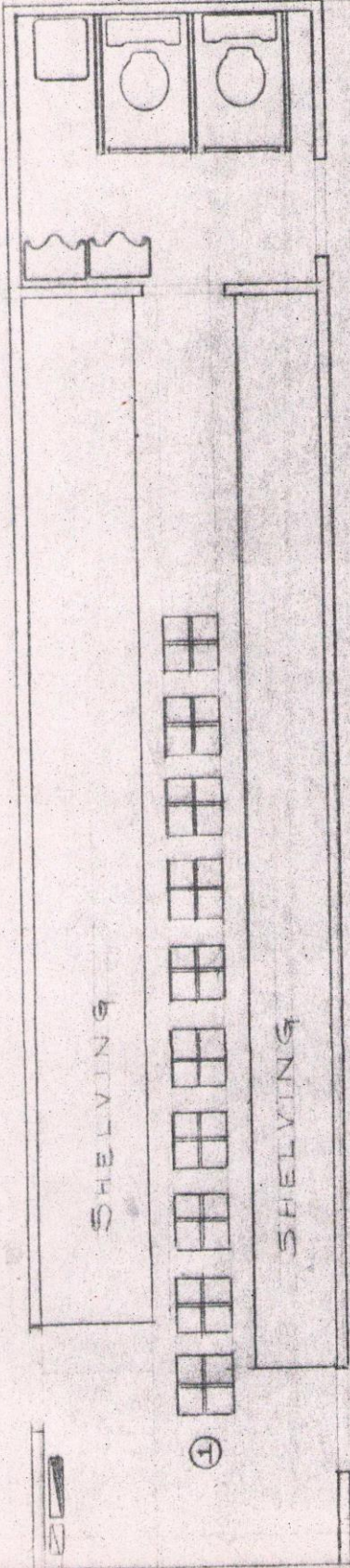

6'x40' STORAGE UNIT

- ① DEAD MAN LOCATIONS
 SAVE ALL STRAPPING MATERIAL
 DEAD MAN TROUGHS FOR FUTURE
 SHIPPING

SHIPPING LOCATIONS FOR TIE DOWN EQUIPMENT



NORTHLAND CAMPS INC.

ASSEMBLY INSTRUCTIONS FOR BREEZEWAY

1. SET FLOOR ON THE GROUND.
2. LAG WALLS INTO POSITION AND LAG.
3. SET THE ROOF ON THE TOP OF THE WALLS.
4. PLUMB AND LAG THE ROOF INTO PLACE.
5. INSTALL THE THRESHOLDS AND LAG INTO PLACE.
6. SECURE ALL LAG SCREWS AND BOLTS TO THE PROPER POSITIONS.
7. INSTALL THRESHOLDS SO THEY FIT FLUSH TO THE ADJOINING TRAILERS.
8. INSTALL THE QUARTER ROUND ALONG THE FLOOR NEXT TO THE WALL.
9. LIFT THE BREEZEWAY AND SET INTO POSITION.
 - A. MAKE SURE THAT THE ANGLE ON THE ROOF IS SET INTO THE SLOTTED AREA UNDER THE DRIP CAP THAT IS LOCATED OVER THE DOOR OF THE ADJOINING TRAILER.
 - B. SECURE THE BOTTOM ANGLES WITH THOSE OF THE TRAILER.



NORTHLAND CAMPS INC.

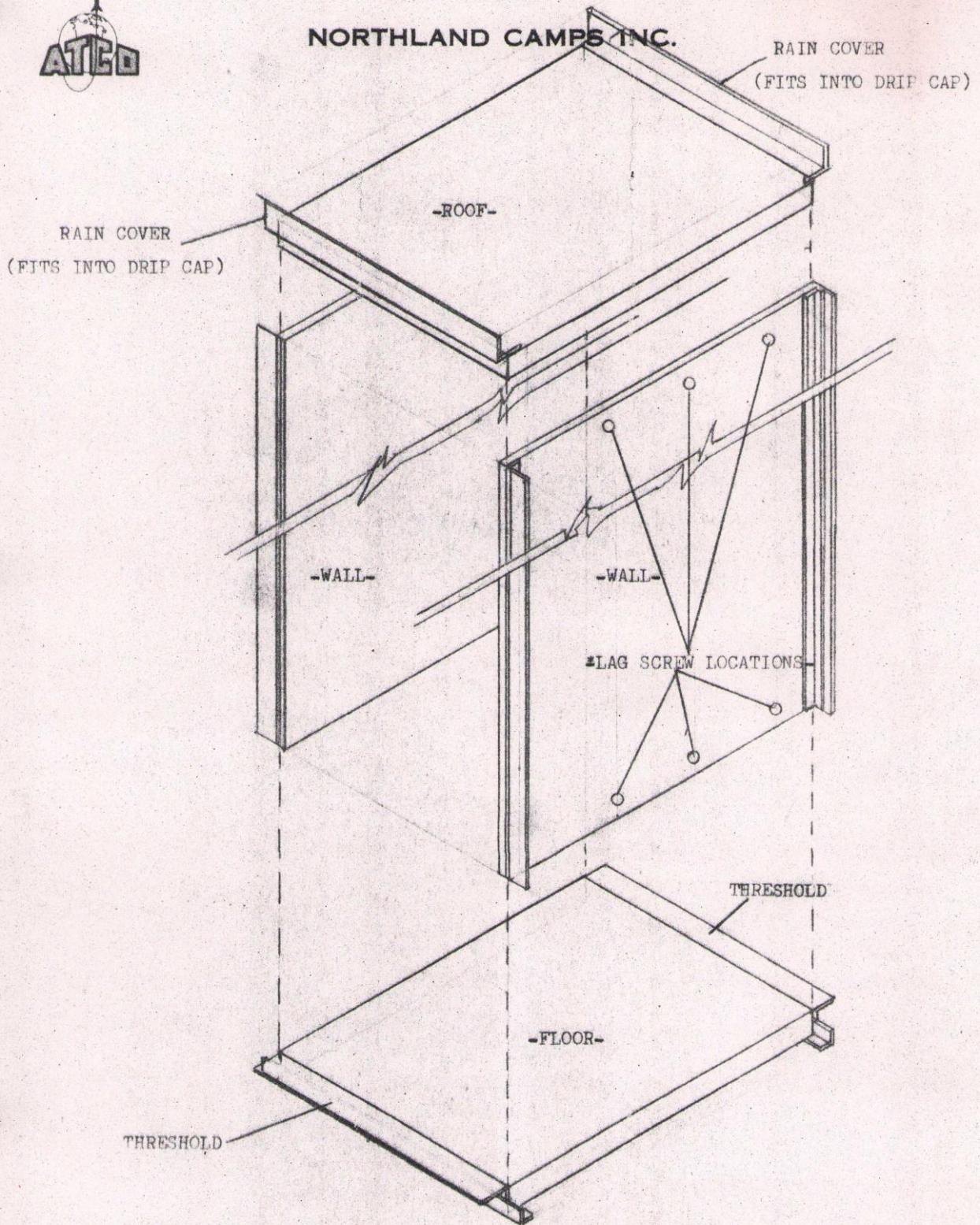



NORTHLAND CAMPS INC.

NAMPA, IDAHO

M A T E R I A L L I S T I N G

- LIVE LOAD -

NASA - STORAGE TRAILER





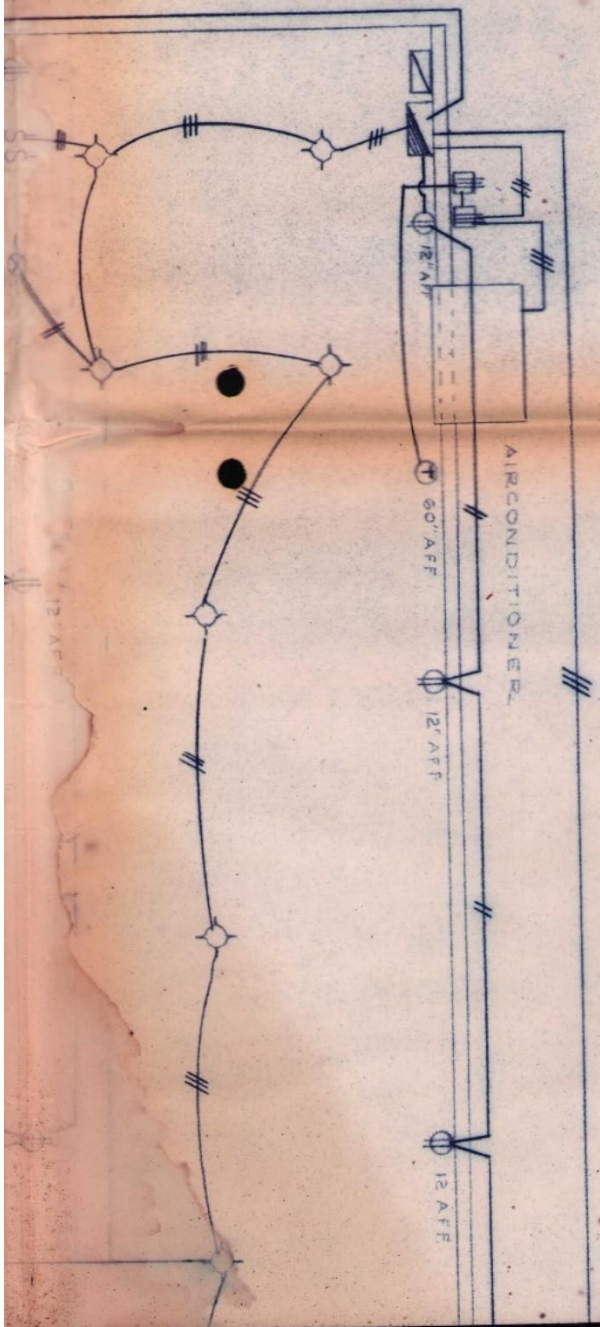

No. of
Items

- 1 - Water Heater - Republic
Mod. 6-EM Serial 65-50488
- 1 - Westinghouse Air Conditioner & Heat Pump
Mod. HB036B1A Serial EF8893
- 1 - 10 lb. CO² Fire Extinguisher - Pyrene
Mod. 34-1B Serial 926503
- 1 - First Aid Kit - Bullard
Mod. 116
- 2 - Water Closets - Kohler
Mod. K-375-PB
- 1 - Hand Basin - Kohler
Mod. K-2792
- 2 - Urinals - Kohler
Mod. K-5024
- 1 - 30' x 3' Shelving - 5 Sections 6' Long
3 Tiers High
- 1 - 30' x 2' Shelving - 5 Sections 6" Long
3 Tiers High
- 1 - Toilet Partitions for Double Water Closet Set Up



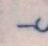

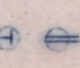
LEGEND

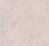
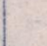
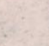
-  Ceiling Light Fixture
-  Exit Light
-  Single Pole Switch
-  Light & Power Panel
-  Communication Panel
-  Indicates No. of Wires
-  Power Connection - 220V
-  Duplex Receptacle - 110V
-  Thermostat
-  Duplex Receptacle - 110V Weather Proof

ELECTRICAL

Power Supply 120/208V 3Φ
 Panel - Combination 3Φ 4W
 1-3P- 100A MAIN BREAKER
 1-3P- 40A BREAKER (AIR COND)
 5-1P- 15A BREAKERS
 2-1P- 15A BREAKERS (SPARE)
 Power Inlet To Be Pile Mat'd
 25' 4" x/w Ground Flexible C
 Ground Rod s/w Connector
 All Wiring To Be Done In R/C
 COMMUNICATIONS SYSTEM (IN
 MS-3100E-24 28 PV CONDUIT
 2-1/4" TERMINAL BLOCKS FOR
 INTER COMMUNICATION SYSTEM

N 60C

(OWNER)

BULKHEAD CONNECTOR
(TYPE-S) 9W APP CONNECTOR
BE SUPPLIED

METALLIC SHEATHED CABLE
(COM) PANEL TO HAVE MS CONNECTOR
OF 3 INCHES JONES MOD #
CONNECTION TO AN EXTERNAL
M

	ELECTRICAL - AS BUILT DRAWING	JUP	1/19/66
NO	REVISIONS	DRAWN BY	DATE
		JUP	1-18-66
		CHECKED BY	SCALE
		G.M.	1/2" = 1'-0"

NORTHLAND CAMPS, INC
NAMPA, IDAHO

8'X40' STORAGE UNIT PROJECT 2398
ELECTRICAL PLAN FOR MANUAL

DRAWN BY JUP DATE 1-18-66
CHECKED BY G.M. SCALE 1/2" = 1'-0"

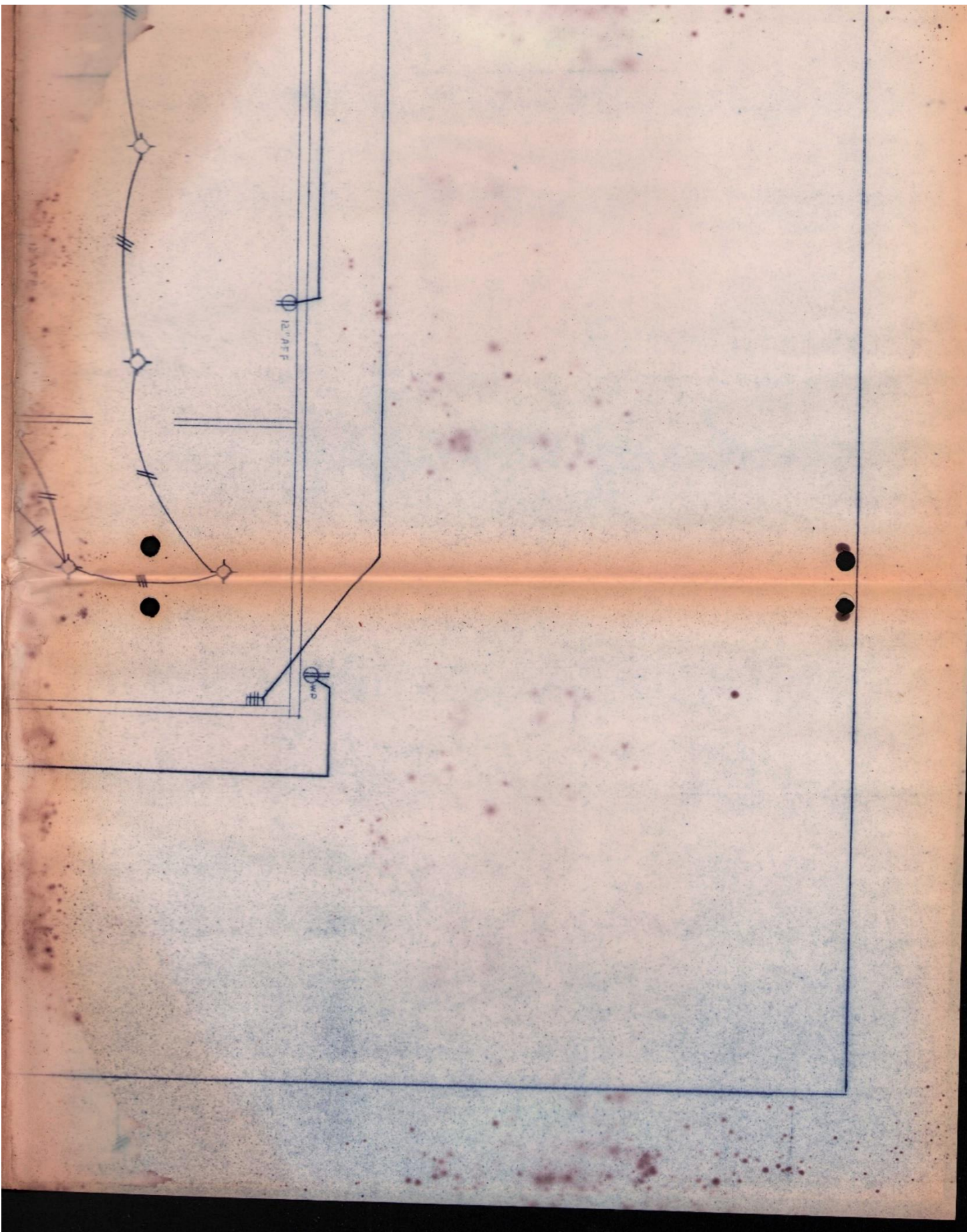

AUTHOR Nasa

TITLE Storage Trailer serial No. 040-60258

Class No. 20-1

Copy No. 

Lent to	Dept.	Date	Date returned



NORTHLAND CAMPS INC.

NAMPA, IDAHO

- MAINTAINANCE OF TRAILER -

NASA TRAILERS, NCI SERIAL NUMBERS: 040-60257, 040-60258, 040-60259,
040-60260

1. Normal cleaning practices pertaining to care of walls, floors, etc., will suffice to prolong life of trailer.
2. Storage & maintenance shelving is of Dexlon Metal & Care consists of tightening bolts to insure proper shelving space.
3. Windows are Hehr 3600 Series and 100 Series and need no special care other than cleaning of glass.
4. Lamp fixtures are incandescent type, precelain coated and need no care other than normal cleaning and bulb replacement.
5. Doors and Superior Type c/w screen need no maintenance other than normal care.
6. Exterior metal is aluminum c/w baked enamel surface and needs no special care other than an occasional washing to remove dirt, etc.
7. All plumbing fixtures have been tested and normal care and cleaning is all that is needed.
8. BE SURE TO FILL WATER HEATER BEFORE ACTIVATING HEAT COILS.
9. BE SURE TO GROUND TRAILER WITH GROUND ROD BEFORE TURNING ON ELECTRICITY.
10. All tools and air conditioners have their own care and maintenance manuals. These procedures should be followed.
11. It is recommended that fire extinguisher be recharged every 12 months.
12. 50 MPH is the design limit for each trailer on the highway.
13. Diffusers in each trailer should be kept free from dust and lint for best operation.
14. Desks are metal and normal cleaning with soap and water will suffice.
15. All desks and filing cabinets are secured to the floor and walls for shipping and should be replaced in exact locations for future shipments.
16. Secure equipment as per drawing enclosed for each trailer.
17. Leveling jacks are located underneath the I-beam crossmembers of the main frame. For use, the retaining pin holding the jack in traveling position is removed, allowing the jack to swing down to operating position. The jack is operated by means of the handle provided. Leveling can be checked by means of the level vials located on the outside corners of the trailer.



NORTHLAND CAMPS INC.

NAMPA, IDAHO

M A T E R I A L L I S T I N G

- LIVE LOAD -

NASA - STORAGE TRAILER

No. of
Items

- 1 - Water Heater - Republic
Mod. 6-EM Serial 65-50488
- 1 - Westinghouse Air Conditioner & Heat Pump
Mod. HB036B1A Serial EF8893
- 1 - 10 lb. CO² Fire Extinguisher - Pyrene
Mod. 34-1B Serial 926503
- 1 - First Aid Kit - Bullard
Mod. 116
- 2 - Water Closets - Kohler
Mod. K-375-PB
- 1 - Hand Basin - Kohler
Mod. K-2792
- 2 - Urinals - Kohler
Mod. K-5024
- 1 - 30' x 3' Shelving - 5 Sections 6' Long
3 Tiers High
- 1 - 30' x 2' Shelving - 5 Sections 6" Long
3 Tiers High
- 1 - Toilet Partitions for Double Water Closet Set Up

PACKING LIST

PROJECT 2388 Storage 040-60258 PAGE 1 OF 1

SHIP TO: EXPORT MARKS	<u>Natl Aeronautics Space Admin</u> <u>Goddard Space Flight Center</u> <u>Greenbelt, Maryland</u>	PACKAGE No. _____	TYPE _____
		NUMBER OF ITEMS _____	
		WEIGHT OF PACKAGE _____ lbs. _____ kilos	

FOR INSTALLATION IN UNIT SERIAL NUMBERS AS FOLLOWS:

040-60257
040-60258
040-60259
040-60260

Item	Quantity Shipped	Quantity Received	Unit	Description of Contents	Quantity Ordered	Quantity Back Ordered	Value	Check	Serial Number
A	10		Only	Hurricane tie down ^{deadmen}		nil			
B	7		✓	tie down cables		✓			
C	4		✓	wheel chocks		✓			
D	4		✓	Leveling jack crank		✓			
E	2		✓	Entrance Steps		✓			
F	4		✓	Electrical Masts		✓			
G	4		✓	Ground Rods		✓			
H	2		✓	Exit Sign Complete		✓			
I	1		✓	Walkway		✓			
J	1		✓	Pinset Hook		✓			
K	1		✓	Long Wrench		✓			
L	1		✓	5-Ton Jack		✓			
M	13		✓	Heart Bolts		✓			

PACKED BY _____

DATE _____



NORTHLAND CAMPS INC.

ASSEMBLY INSTRUCTIONS FOR BREEZEWAY

1. SET FLOOR ON THE GROUND.
2. LAG WALLS INTO POSITION AND LAG.
3. SET THE ROOF ON THE TOP OF THE WALLS.
4. PLUMB AND LAG THE ROOF INTO PLACE.
5. INSTALL THE THRESHOLDS AND LAG INTO PLACE.
6. SECURE ALL LAG SCREWS AND BOLTS TO THE PROPER POSITIONS.
7. INSTALL THRESHOLDS SO THEY FIT FLUSH TO THE ADJOINING TRAILERS.
8. INSTALL THE QUARTER ROUND ALONG THE FLOOR NEXT TO THE WALL.
9. LIFT THE BREEZEWAY AND SET INTO POSITION.
 - A. MAKE SURE THAT THE ANGLE ON THE ROOF IS SET INTO THE SLOTTED AREA UNDER THE DRIP CAP THAT IS LOCATED OVER THE DOOR OF THE ADJOINING TRAILER.
 - B. SECURE THE BOTTOM ANGLES WITH THOSE OF THE TRAILER.



NORTHLAND CAMPS INC.

NAMPA, IDAHO

M A T E R I A L L I S T I N G

- LIVE LOAD -

NASA - STORAGE TRAILER

No. of
Items

- 1 - Water Heater - Republic
Mod. 6-EM Serial 65-50488
- 1 - Westinghouse Air Conditioner & Heat Pump
Mod. HB036B1A Serial EF8893
EF8893?
- 1 - 10 lb. CO² Fire Extinguisher - Pyrene
Mod. 34-1B Serial 926503
- 1 - First Aid Kit - Bullard
Mod. 116
- 2 - Water Closets - Kohler
Mod. K-375-PB
- 1 - Hand Basin - Kohler
Mod. K-2792
- 2 - Urinals - Kohler
Mod. K-5024
- 1 - 30' x 3' Shelving - 5 Sections 6' Long
3 Tiers High
- 1 - 30' x 2' Shelving - 5 Sections 6" Long
3 Tiers High
- 1 - Toilet Partitions for Double Water Closet Set Up